

BACK VIEW

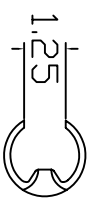

RIGHT VIEW



TOP VIEW

FLOAT TREE

USE FLOAT HOLDERS AS ELECTRICAL  
CABLE GUIDES

ROUTE ALL ELECTRICAL CABLES  
BETWEEN FLOAT TREE AND  
HOLDERS. LEAVE ENOUGH CABLE TO  
REMOVE FLOAT TREE FOR SERVICE.

FLOAT TREE:  
1.25" OR 1.5" SCHEDULE 40 PVC  
PIPE TO 1" LESS THAN THE  
PUMP CHAMBER FLOOR AND  
RISER TOP

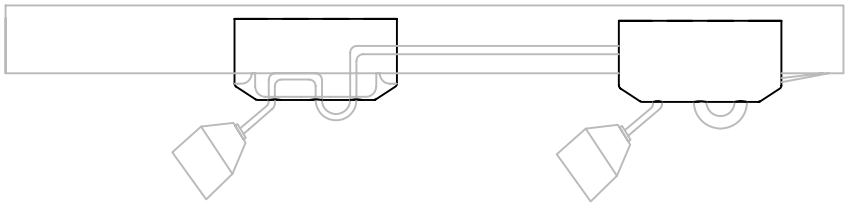

PART# STF-FHHW	DATE: 09/21/06
MATERIAL: PVC	REV: A
DRAWN BY: JASON MAY	APPROVED BY:
DESCRIPTION: FLOAT TREE FLOAT HOLDER HARD WIRE	