

FLOAT TREE

BACK VIEW

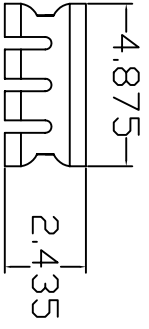

RIGHT VIEW

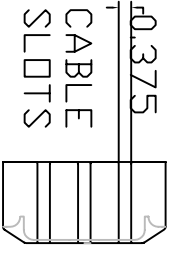

TOP VIEW

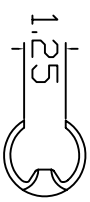

USE FLOAT HOLDERS AS ELECTRICAL
CABLE GUIDES

ROUTE ALL ELECTRICAL CABLES
BETWEEN FLOAT TREE AND
HOLDERS. LEAVE ENOUGH CABLE TO
REMOVE FLOAT TREE FOR SERVICE.

FLOAT TREE:
1.25" OR 1.5" SCHEDULE 40 PVC
PIPE TO 1" LESS THAN THE
PUMP CHAMBER FLOOR AND
RISER TOP

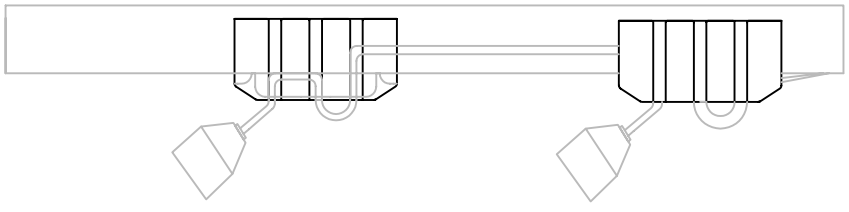

PART# STF-FHPB	DATE: 09/14/06
MATERIAL: PVC	REV: A
DRAWN BY: JASON MAY	APPROVED BY:
DESCRIPTION: FLOAT TREE FLOAT HOLDER PIGGY BACK	

